

DETOUR PLAN LEGEND

- ⊥ SIGN ON TEMPORARY SUPPORT
- ⊥ SIGN ON PERMANENT SUPPORT (EXISTING/PROPOSED)
- ⊥ ⊥ TYPE III BARRICADE (WITH/WITHOUT SIGN)
- PCMS TRAFFIC CONTROL SIGN PCMS (PORTABLE CHANGEABLE MESSAGE SIGNS)
- ▨ WORK SPACE
- ▨ TRAFFIC CONTROL COVERING SIGNS TYPE I, OR TYPE II (BLANK ORANGE PANEL TYPICAL FOR ALL COVERING)
- TRAFFIC FLOW/DETOUR ROUTE

GENERAL NOTES: TRAFFIC CONTROL AND DETOURS

SEE THE TRAFFIC CONTROL PLAN FOR APPLICATION OF THE DETOURS.

PORTABLE CHANGEABLE MESSAGE SIGNS (PCMS) SHALL BE LOCATED BY WISDOT NORTHWEST REGION TRAFFIC SECTION.

SEE SDD "BARRICADES AND SIGNS FOR MAINLINE CLOSURES" FOR ADDITIONAL DETAILS NOT SHOWN ON THIS PLAN.

THE EXACT NUMBER, LOCATION AND SPACING OF ALL SIGNS AND DEVICES SHALL BE IN ACCORDANCE WITH THE LATEST EDITION OF THE MUTCD. ADJUSTMENTS TO FIELD CONDITIONS SHALL BE APPROVED BY THE ENGINEER.

ALL SIGNS INAPPROPRIATE TO THE STATUS OF THE TRAFFIC CONTROL PLAN, INCLUDING PRE-EXISTING SIGNING IN THE VICINITY, SHALL BE COVERED OR REMOVED AS SPECIFIED IN THE PLANS OR AS DIRECTED BY THE ENGINEER IN THE FIELD.

THE SPACING BETWEEN TRAFFIC CONTROL SIGNS SHALL BE ADJUSTED TO NOT CONFLICT WITH EXISTING SIGNS AND SHOULD PROVIDE A MINIMUM OF 200' (500' DESIRABLE) CLEARANCE TO EXISTING SIGNS THAT WILL REMAIN IN PLACE.

ALL DIAMOND SHAPED "W" AND "WO" SIGNS ARE 48"x48" UNLESS OTHERWISE NOTED.

ALL M3 SERIES SIGNS (NORTH, EAST, SOUTH, WEST) WHICH ARE PART OF ANY DETOUR ROUTE MARKER SIGNING ASSEMBLY OR ATTACHED TO ANY WARNING SIGN SHALL BE BLACK MESSAGE ON WHITE BACKGROUND.

ALL M05 AND M06 ARROW SIGNS SHALL BE THE SAME AS "M" SIGNS EXCEPT THAT THE BACKGROUND IS ORANGE.

IF A "STOP" SIGN MUST BE REMOVED FOR A WORK OPERATION, A TEMPORARY "STOP" SIGN SHALL BE PLACED PRIOR TO THE SIGN REMOVAL, OR A FLAGGER SHALL BE PROVIDED UNTIL THE SIGN IS RE-ESTABLISHED.

SIGNS THAT WILL BE IN PLACE LESS THAN 7 CONTINUOUS DAYS AND NIGHTS MAY BE MOUNTED ON PORTABLE SUPPORTS.

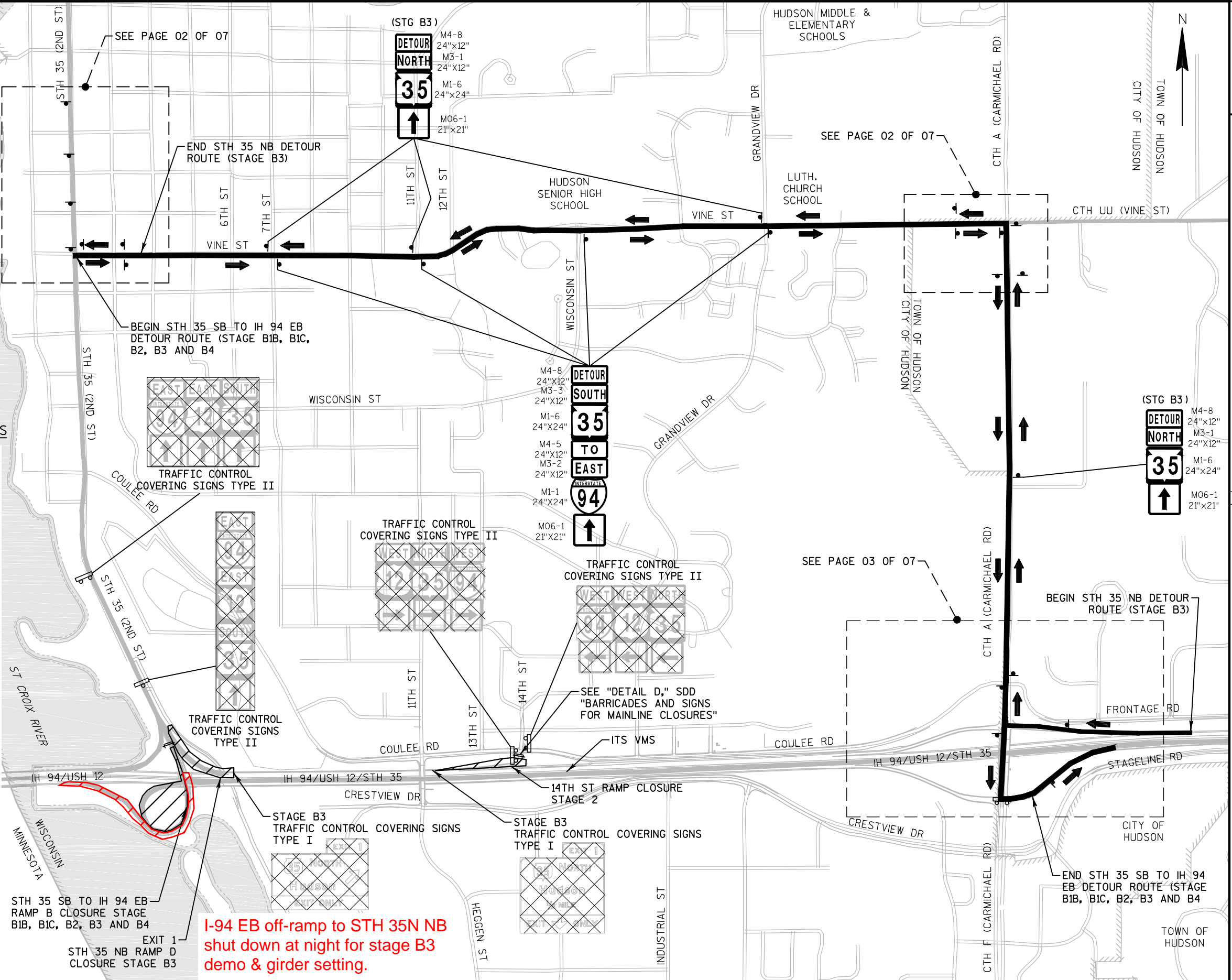

I-94 EB off-ramp to STH 35N NB shut down at night for stage B3 demo & girder setting.

SAVE FOLDER PATH: \SEH\F1\PROJECTS\U2\WITNW\124688\5-FINAL-DSGN\50-FINAL-DSGN\40-TRANS\HWY\CIVIL_3D\10200675\SHEETS\PLAN